

PP-RCT (transition) unions 20-63 mm

for hot water systems

Range extension



New products

PP-RCT union brass nut

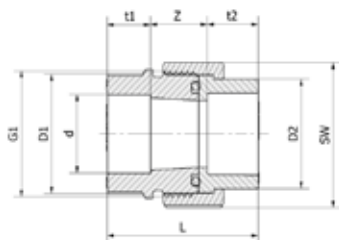

d	Item Code	L ₁	t ₁	z ₁	L ₂	t ₂	z ₂	D ₁	D ₂	kg
20	5152 45601	1"	31	27	16	16	18,5	50,5	37	0,090
25	5152 45602	1 1/4"	36	36	18	18	18,5	54,5	47	0,150
32	5152 45603	1 1/2"	45,5	41	20	20	19,5	59,5	55	0,210
40	5152 45604	2"	56	52,5	22	22	22,5	66,5	66	0,320
50	5152 45605	2 1/4"	66	59	25	25	23,5	73,5	72	0,367
63	5152 45606	2 3/4"	81,5	73,5	29	29	24,5	82,5	87	0,490

PP-RCT union brass male

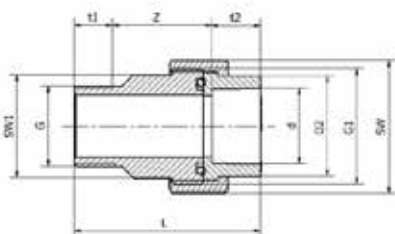

d x R _p	Item Code	L ₁	t ₁	z ₁	L ₂	t ₂	z ₂	D ₁	D ₂	kg
20 x 1/2"	5152 45302	1"	27	15	16	24,5	55,5	37	26	0,180
25 x 3/4"	5152 45305	1 1/4"	36	16,5	18	36	70,5	47	32	0,330
32 x 1"	5152 45308	1 1/2"	41	19,5	20	37	76,5	55	38	0,480
40 x 1 1/4"	5152 45311	2"	52,5	21,5	22	36	79,5	66	47	0,680
50 x 1 1/2"	5152 45313	2 1/4"	59	21,5	25	44	90,5	72	53	0,859
63 x 2"	5152 45315	2 3/4"	73,5	26	29	46,5	101,5	87	67	1,363

PP-RCT union brass female

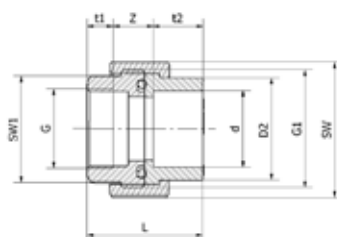

d x R _p	Item Code	L ₁	t ₁	z ₁	L ₂	t ₂	z ₂	D ₁	D ₂	kg
20 x 1/2"	5152 45402	1"	27	15	16	11,5	42,5	37	26	0,146
25 x 3/4"	5152 45405	1 1/4"	36	16,5	18	12,5	47	47	32	0,251
32 x 1"	5152 45408	1 1/2"	41	19,1	20	13,4	52,5	55	38	0,341
40 x 1 1/4"	5152 45411	2"	52,5	21,5	22	14	57,5	66	47	0,520
50 x 1 1/2"	5152 45413	2 1/4"	59	21,5	25	14,5	61	72	53	0,609
63 x 2"	5152 45415	2 3/4"	73,5	25,7	29	13,8	68,5	87	67	0,930

PP-RCT (transition) unions 20-63 mm for hot water systems

Range extension



Technical data

For use in primary hot & cold water applications according:

- ◆ ISO 15874 Class 1/10, 2/10, 4/10, 5/8 bar
- ◆ DIN 8077/8078 class 20°C/10 bar, 70°C/10 bar
- ◆ PP-RCT 100% virgin material RA7050 by Borealis (premixed - no recycled material)
- ◆ Brass alloy quality complies with drinking water criteria of UBA (German Environment Agency)
- ◆ All threads according to EN 10226 (ISO7)

